

SELLINDGE VILLAGE NEWS

JANUARY 2016

Edition 621

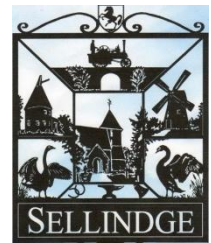

SELLINDGE VILLAGE HALL TABLE TOP FAIR

Saturday January 2nd 2015 from 9am to 1pm. Tables can be booked in advance for £5.00 per table. Please phone 01303 813 475 or on the day, if any left at £10. Next Table Top Fair Saturday February 6th 2016.

PILGRIMS HOSPICE JUMBLE SALE



The Pilgrims Hospice Jumble Sale will be held on January 16th 2016 in the Village Hall. Doors open at 1pm (please note early start). This is your last chance for a big new year clear out. For collection please call Jane Gaskin 01303 812 435 or Ann Bryant 01303 813 372. Jumble can be left at the hall on the morning of the Jumble Sale.

Donations for Raffle, Cake Stall or any unwanted Christmas Presents will be most welcome.

Thank You.

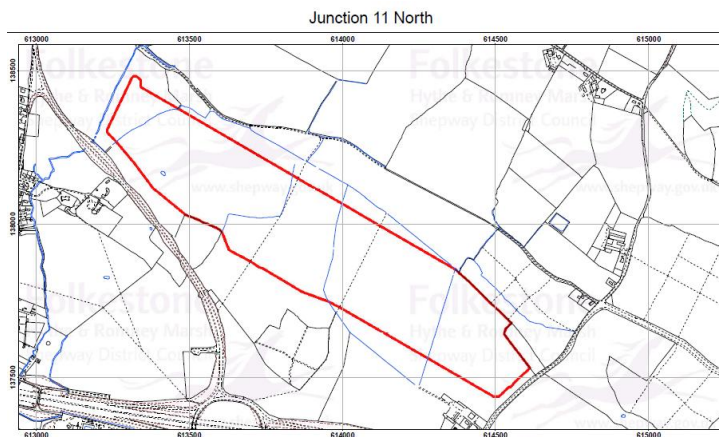

PROPOSED PERMANENT M20 LORRY AREA

In the 2015 Autumn Statement the Government set funds aside to build a permanent area where lorries can wait their turn to cross the Channel and do not cause disruption to local people or the economy. The Chancellor stated the Government's preference for a site at Stanford but was clear that alternatives would also be considered on an equal basis ahead of making any final decision. The Government wishes to fully test the case for a permanent lorry area as an alternative solution to Operation Stack, where lorries are temporarily queued on the M20 when there are delays and closures at the Port of Dover and Eurotunnel. A number of temporary solutions have previously been tried and investigated, but none have provided a satisfactory resolution.

It has not yet been decided on whether any Lorry Area will be used solely as a response to Operation Stack, with a number of other uses under consideration. The main alternatives comprise:

1 - Emergency Use – For use as a Lorry Area to accommodate lorries currently queued as part of Operation Stack.

2 - General Disruption – Emergency lorry holding area which reduces or removes the need for Operation Stack and also for the existing queue management on the A20 approaching Dover and/or on the M20 approaching the Eurotunnel terminal.

3 - General Disruption and Overnight Parking – Emergency lorry holding area as above, additional chargeable basic overnight parking. Free parking provided for lorries held for queue management or Operation Stack.

4 - General Disruption and Truckstop – Emergency lorry holding area as above plus a truckstop (a lorry focussed motorway service area). Free parking provided for lorries held for queue management or Operation Stack.

This consultation is a non-statutory consultation to enable us to obtain a broad range of feedback on general options and in due course it will be followed by a formal consultation on any preferred site that will include greater detail on the design, layout and operation, and any associated, necessary highway works.

- There will be another consultation exhibition, where you are able to ask questions and pick up the document Monday 11th January 2016, 2pm-8pm, Sellindge Sports and Social Club, Swan Lane, Sellindge.

The consultation documents can be found at. You can comment online or download a copy of the consultation.

<https://www.gov.uk/government/consultations/management-of-freight-vehicles-through-kent>

If you would like to comment on the proposals the consultation deadline is midnight on Monday 25th January 2016.

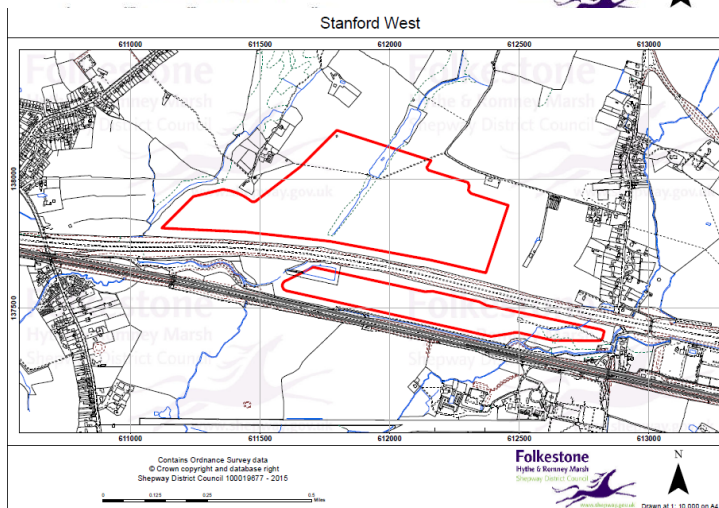

Your Council met on 8th December, the normal second Tuesday in the month and it is expected that the meetings will continue in this manner during 2016. The dates for the monthly meetings are normally in each edition of the News. Although the headings on the agenda appear the same the content is usually different.

Planning – The first of the Highways England exhibition to show the proposed lorry parking solutions to Operation Stack (OS) will have taken place by the time this goes to print and it is expected there will be opposing opinions. There will be two representatives from Shepway District Council at the next Parish Council meeting.

In addition your Council is also a member of the group looking at the changes to M20 Junction 10 and the new M20 10a junction that is being developed. Another meeting is due to take place later in the New Year, any outcomes will be made public via the Sellindge Newsletter. Both these proposed developments are being led by central government so it will take sound constructive statements to make them listen to the comments being put forward by local people. The lorry parking at the Airport Café and Otterpool Quarry continues to cause a nuisance to local people, your Council along with Shepway Councillors continue to monitor and reply to the planning department at Shepway when any new information is sent.

A Development Company called Quinn Estates (QE) have submitted an application to Shepway District Council to have the Bucknell Trust land listed for development in the next Shepway Local Plan. Your PC have already explained to QE that the replies from our first consultation on our Neighbourhood Plan did not want to see any further large developments take place. Unfortunately this does not stop QE from making the submission to SDC and it will be up to the planning policy team at Shepway to make the final decision as to whether or not this land will be included in the new Local Plan. Your Council continues to monitor the situation and will be responding accordingly when the New Local Plan is out for consultation, although dates for the consultation are yet to be confirmed.

Neighbourhood Plan – Due to the extra consultation taken close to the Christmas holidays it was agreed by the working group to delay any further meetings until late in January. Again new information will be passed on in this Newsletter. According to the Group leader Mr Jim Boot both events in Sellindge Primary School and Brockhill School went well. A brief outline of issues put forward by the children at Sellindge was considered, in the main their comments were well thought out and useful. More work is needed on the report though and this will be taken to the PC after the working group have considered it.

Correspondence – There were two items listed, 1 was the letter from the National Grid, which was a copy sent to residents in Sellindge who would be affected by the work taking place at the Converter Station and no. 2 was a consultation document on the future of the Community Infrastructure Levy (CIL) needs a response from your Council.

Other items – After the PC meeting it was noted that our PCSO has changed – again – his name is David Garland and he can be contacted via the police 101 number. By dialling 101 it will take you directly to the Kent Police Customer Services and then you can ask to be put through to him, or any other department.

The mince pies, fruit juice and wine supplied by the Chairman was enjoyed by those who stayed after the meeting, it made a pleasant end to the last meeting of the year.

Dog Poo Bags – Your Council is still providing these for use free of charge, members consider that this has made a difference to the village. The Chairman and Councillors would like to say ‘thank you’ to all those who are taking the time and trouble to pick up after their dog/s.

The first of the 2016 meetings is on 12th January, in the Durling hall at 7.30pm so please do come along

Your Parish Council would like to wish all residents of Sellindge a Prosperous and Happy New Year.



PROPOSED M20 JUNCTION 10a

Some of you may think, I remember something like this before. Well you are right, a community consultation took place in 2008. There was a proposed option and 2 alternatives. The consultation found that the proposed option was the preferred option. In 2010 the proposed plans were shelved, and re-started in 2015. Now we have the 2nd round of the consultation which starts on Thursday January 14th until Thursday March 16th. You will be able to view the consultation documents and complete consultation online at www.highways.gov.uk/m20j10a or attend the exhibition in the new Ashford Market on Thurs 21st 12 Noon - 8pm Fri 22nd 10am - 8pm and Sat 23rd 9.30am - 3.30pm

There will be 1 day events at the Ashford Asda Wed Feb 3rd and the Designer Outlet Wed Feb 10th both 11am – 3pm

FROM YOUR DISTRICT COUNCILLORS

Jenny Hollingsbee and Susan Carey, Ward Councillors for North Downs West, Shepway District Council

Jenny.hollingsbee@shepway.gov.uk 01303 812 066 susan.carey@shepway.gov.uk 01303 670 561

Most people will be well aware of the government's proposals for a permanent lorry park at one of two alternative sites near Stanford. Highways England have launched a non-statutory consultation called 'Managing freight vehicles through Kent' (go to www.gov.uk and search for this title to find a copy online).

As well as the two sites there are four options for each site:

Alternative 1 – use the site only during Operation Stack.

Alternative 2 – use during Operation Stack and to avoid TAP (when traffic is slowed on the A20 approaching Dover and which then backs the traffic up as far as Folkestone) which now happens several times a week.

Alternative 3 – As alternative 2 plus provide overnight parking to avoid the flyparking that takes place across our district by lorries.

Alternative 4 – As 3 plus a full Motorway Service area.

Site 1 at Stanford West would have access from a slip road on the M20 and lorries could both enter and leave the site without using local roads. It is also less prominent visually and makes use of the existing facilities at the Stop 24 site (it would be on both sides of the M20). Site 2 at Junction 11 North would bring the lorries off the motorway at the existing Junction 11 slip road and they would turn left onto the B2068 (Stone Street going to Canterbury). They would then travel a short way along this road to a new roundabout which would allow them to turn right into the site. Our view is that we don't want a giant lorry park at all but that site 1 is the 'least bad' option because of the direct access on and off the motorway. Of the alternatives, we believe alternative 3 is preferable as it would be used for our year round problems and not just Stack. We are against alternative 4 (the full motorway service area) as it would add to the noise and light pollution as well as taking up land that could otherwise park lorries.

The proposal is totally outside the normal planning procedures and **does not require permission from either Shepway District Council or Kent County Council**. Decisions will be made by the Secretary of State for Transport using his powers in the Highways Act.

In addition to the exhibitions that have already been held, there will be staffed exhibitions at the Civic Centre in Folkestone on 4th and 5th January, Sellindge Sports and Social Club on 11th January and Hawkinge Community Centre on 12th January.

We are both dismayed at how little detail there is about the two sites in the consultation just vague blobs on a map but there is no doubt the sites would be vast and (even with screening) will be a terrible blot on our lovely landscape. Whether you support or oppose the proposals you only have till midnight 25 January 2016 to respond to Highways England, please make your voice heard.

Meanwhile, Shepway's officers have issued over 100 Fixed Penalty Notices a week to lorries parked in the new restricted areas which include the A20 through Sellindge. The notices have been up since November and the fines started mid-November so it is too early to judge the effects but we will keep you updated.

Jenny attended St Marys' Church Christmas Fair, the Primary School Christmas Fair and Nativity Play and Celebration Assembly as well as many other events throughout the Ward. She would like to thank all those who work so hard for the Village, particularly Nigel Fursdon for the Monthly Newsletter, Michael Garrod and his team for the Pop-in and all those who tirelessly work for the School, Village Hall, Sports Centre and other Clubs. Your efforts are very much appreciated. (For information Jenny has a fault on her landline and cannot pick up messages – please can you use her mobile 07887 918 458.)

We wish you all a Happy New Year.

WEATHER FACTS FOR NOVEMBER 2015

Minimum temp. -4.00°C Sun 22nd.

Mean night temp. 6.93°C

Maximum temp. 20.00°C Sun 1st.

Mean day temp. 12.93°C

A combination of low barometric pressure and winds of up to mid 40mph from the west or south west combined with high pressure from Europe made the weather unusual for a November. Sunshine was down on average but the temperatures both day and night were around 3°C above normal. The first frost of the winter was not recorded until Sun. 22nd. Rainfall from 17 days was 74.93mm (2.95in) only 76.62% of the average for the month.

SELLINDGE GARDENERS' ASSOCIATION

At the December meeting the members and guests enjoyed a Christmas Social Evening in the Village Hall.

Which included a Beetle Drive & raffle followed by a Christmas Buffet which included Betty's Lovely Christmas Cake which was enjoyed by all.

The next meeting will be held on Wednesday 20th January 2016 in the Durling Hall with a Fun Quiz Night.

Members are asked to bring a Photo of them self's as a child i.e. (School Photo) for one of the Quiz's Thank you.

We are still eager to recruit some new Members so why not make a New Year Resolution and come along, you are under no obligation to join, and you will get a free cuppa and biscuit. You will be most welcome.

If anyone is Interested in the Holiday to Norfolk in September 2016 please contact Elaine.

The Garden Club Committee would like to wish you all a Very Happy and Prosperous New Year in all you grow!

FROM YOUR KCC COUNCILLOR Susan Carey, Member for Elham Valley, KCC –
01303 670 561 or e-mail susan.carey@kent.gov.uk

Most of my time at County is taken up with the budget which gets harder to balance every year. It's not just that our government grants reduce, but also that demand for social services continues to rise. The Chancellor has now announced that government grant will be phased out entirely by 2020 and just before Christmas we received the news that the grant made to Kent for 2016/17 would be reduced £111m (down from £161m this year) which is worse than our most pessimistic assumptions.

The government recognises that there has been rising demand for social care from an ageing population and has said that an extra 2% council tax can be levied specifically for this. For Kent this would raise £11m which is well short of what's needed. We now face some very unpalatable choices and a busy time as we have to publish our budget by 11th January if it is to meet the deadlines for scrutiny and debate.

There are two pieces of good news. Work begins this month (January) on the next phase of the superfast broadband project for rural areas which has been jointly funded by KCC and the government. If you go to www.kent.gov.uk and search for 'broadband' you will find a postcode checker which will show if you are covered by this latest programme will take broadband coverage in Kent to over 95% of households. The Prime Minister has promised that broadband will be available to all households but we do not yet have any details on how this will be delivered or funded.

The second piece of good news is that (via KCC) the Government has allocated £5.1m to help get the Folkestone seafront development under way. The grant will fund flood protection measures, upgrades to utilities and improvements to Marine Parade.

NEWS FROM AGE UK LYMINGE...



Last year – 2015 – more people than ever before used our friendly and flexible services. We asked some of our users and volunteers what they thought about our work and here is some of what they said: ... A great place for people who want to chat and meet friends ... Coming to Age UK helps people live again...

A god-send ... caring...helpful staff ... wonderful meals ... fills my day ... a bit of fun ... I didn't think it was for me, but I started coming once a week now I'm here nearly every day ... The services are good value for money...

During 2015, as well as all our ongoing services and activities, we have been busy demonstrating what a dynamic contribution older people make to their local communities. People who use the centres presented their work in an art exhibition, we published all the recipes regularly used by volunteer cook, Irene, in a cook book (copies still available for £5!), we organised two holidays and ran a whole host of family-friendly fundraising events. We've made our buildings even more welcoming to the general public, especially in Hythe where we now have a lovely new entrance and cafe terrace overlooking Oaklands Park.

January and February can be hard months – bad weather can keep people isolated and homes can be chilly. So please join us for an activity or lunch, or pop into our café or shop and find out more about what we do.

Don't forget our **free Information and Advice** service is available to help advise on keeping warm, reducing heating costs and many other subjects. Please call 01303 269 602 for an appointment. You can meet the team at the centre or they can visit you at home.

For more information about any of our events or services please call 01303 269 602 or email co@ageukhl.org.uk or come and say hello in person – we are at Everist Court, Station Rd, Lyminge, CT18 8HQ. Full information available at www.ageuk.org.uk/hytheandlyminge (including daily menus for the next two weeks) and you can find us on Facebook (AgeUkHytheandLyminge) and Twitter (@ageukhl)

SELLINDGE POP IN – A place for all age groups – Sellindge Village Hall

The Pop – In is open on Mondays and Wednesdays from 8am to 12 Noon and Tuesdays 8am to 3.00pm, except the Tuesdays when Hi Kent are at the Pop In, that week it will be 4.00pm.

There is a vast section of books, all at 20p and most of the bric – a – brac is 50p.

You can pick up information leaflets from Age UK and other organisations.

****NEW**** for Monday – Unisex Hair Cutting from £5 from 9.30am to 12 Noon. Scissor over comb – All welcome.

Tuesday 26th Suzie will be in offering File and Polish, Mini Manicure or Classic Manicures.

Tuesday 12th Chiropodist will be at the Pop In (in the Committee Room) from 8.30am to 1.00pm the cost is £14 for general maintenance and £24 for more through work.

Tuesday 12th – Hi Kent the Kent charity for the deaf, for advice, serving hearing aids etc from 2pm to 3.30pm.

Date to confirmed – Cathy from Age UK will be at the Pop – In with lots of information for people over 50.

****NEW**** - Every Tuesday A lovely selection of Handmade Cards which can be made to order, from £3

Mums with children very welcome, we have a nice box of toys for the children to play with, while you have a cuppa. Post card size adverts can be placed in the Outside Village Hall notice board for a small fee of 25p per week. To have your advert put in see Michael in the Pop – In.

Further dates for East Kent Foot Care 2016 – February 23rd, April 5th and May 10th.

SELLINDGE WOMENS WEDNESDAY LUNCHEON CLUB Venue for January is The Dukes Head, Sellindge on Weds 27th. 12 Noon for 12.30pm. will members let June Wales know on 01303 814 676 by Weds 20th

DAVID GARLAND PCSO 46053864 – Shepway Rural Officer – Tel 101 – E Mail 53864@kent.pnn.police.uk

Hope you are well, General update for the area for the last month:

In general we had another reasonable month in regard to Crime and disorder:

However I have had reports of theft from and damage to motor vehicles, in particular 2 of these relate to fuel being stolen from the vehicles, please follow the link for preventative advice <http://bit.ly/21FpuCI>

As we now approach the New Year, I felt it appropriate to pass on to you for your parishioners advice the following links. Shutting the gate on Rural crime leaflet offers information and advice on all areas of rural crime and disorder issues. Please follow link <http://bit.ly/1IUFtB1>, I have had a report concerning possible rogue traders and cold callers, the following link offers advice and contact numbers on this issue <http://bit.ly/1RDNW2J>. It is also the time of the year when we may well increase the use our Credit and Debit cards, the following link provides advice with regard to plastic card fraud <http://bit.ly/1lubaMO> in addition this the following link offers security advice with regard to the use of cash machines <http://bit.ly/1lubAmh>. If you have any concerns or feel that you have been a victim of fraud this link is for reporting the incidents directly to Action Fraud is <http://bit.ly/1d39KMP>. As it is likely people will be increasing socialising attending functions or family and friends I though it opportune to promote advice on staying safe on nights out <http://bit.ly/1NG3Dow>, please ensure homes and vehicles are secure some useful advice in the following link <http://bit.ly/1hheSfD>.

St MARYS CHURCH SELLINDGE

First Sunday Celebration Praise. 11 am 3rd January in the Durling Hall

Everyone is very welcome to come and join us – no previous experience necessary

A modern informal gathering ‘It’s church Jim but not as you know it’

Please come and give it a try – if you want to know more please give me a call on 01233 501 039

Dear friends

The Rectory, Mersham

I hope that you all had a very happy and peaceful Christmas; it is hard to believe that it is over for another year. The tinsel and the decorations will soon be packed away and safely stored for next year. Rudolf and the other reindeer will be having a well-deserved rest, probably thinking about their summer holidays, to be fully recovered by next Christmas. Santa’s sleigh will have been parked up for another year, a chance for it to have its annual service. How easy it is to set aside Rudolf, Santa and the Christmas decorations for another year. Unfortunately it is just as easy to think of Jesus in the same way. Out He comes every year, the focus of our celebration, ‘*the reason for the season*’, only to be put away again like our decorations, after the celebrations, only to be brought out again next year. We celebrate His birth at Christmas, sing carols, listen to Christmas music, exchange Christmas cards, many with pictures of His birth, we party and celebrate His Birthday. There is of course no reason why we should not party and have a good time to celebrate this special birth.

What happens in the New Year is important. The Dog’s Trust produced a Christmas slogan which I have stolen and adapted to say ‘*Jesus is for Life, not just for Christmas*’. It is so easy to put Jesus out to pasture until next year, to put Him away for now, but that is not the reality and importance of the birth that we have just celebrated. If you let Him into your life, He will be with you through good and bad times all year, why not come and meet Him with us this year and get to know Him, not just for Christmas.

With every blessing for 2016 Ian

- **Services for January**
- Sunday 3rd January 11 am Celebration Praise in the Durling Hall
- Sunday 24th January 11 am Parish Communion Service in the Parish Church
- Sunday 7th February 11 am Celebration Praise in the Durling Hall

I am very sad to report that the following funerals have taken place at Sellindge church.

June Price on Friday 27th November, with Committal at Charing Crematorium.

Marjorie Pilcher on Monday 14th December, with private committal at Hawkinge Crematorium.

Roy Shew on Tuesday 22nd December, with committal at Hawkinge Crematorium.

Our thoughts and prayer are with all the families and friends.

Please feel free to contact either myself, Ian, on 01233 501 039 or Richard on 01303 812 697 if you think that there is anything that we can help you with or if you want to enquire about a Christening or Wedding.

Part of the A20 Benefice comprising the parishes of

Brabourne, Mersham, Monks Horton, Sellindge, Smeeth and Stowting. www.A20churches.org.uk

WHAT'S ON AND WHERE JANUARY 2016 *Stick it on your fridge or pin board*

WEEKLY EVENTS

- MONDAY** PILATES – 9.15am – 10.15am – Village Hall (Main) - 07543 543 373 vsaker@hotmail.com
PILATES – 10.15am – 11.15am – Village Hall (Main) -07543 543 373 vsaker@hotmail.com
QIGONG – 11.15am – 12.15pm Village Hall (Main) - - 07543 543 373 vsaker@hotmail.com
RAINBOWS – 4.00pm – 5.00pm Village Hall (Main) - - 812 297 (Term time)
BROWNIES -- 5.15 - 6.45pm Village Hall (Main) - - 812 297 (Term time)
GIRL GUIDES - - 5.45 – 7.15pm Village Hall (Durling) - - 07801 572 300 (Term time)
LINE DANCING – Beginners 7.30pm – 9.30pm Village Hall (Main) – 07753 274 913
- TUESDAY** SELLINDGE BABY & TODDLER GROUP – 9.15am – 11.30am Village Hall (Main) – 01303 812 262
NHS EAST KENT HEALTHWALKS – 10.15am Village hall car park – 01303 814 014
CRAFT GROUP – 1pm to 3pm Sellindge Sports & Social Clubhouse 07546 532 603 ****NEW****
PULSE – 5.30pm to 6.30pm Sellindge Sports & Social Clubhouse
LINE DANCING – 1pm to 2.45pm Village Hall (Main) – 01303 813 098
LINE DANCING -- Intermediate Level 7.30 - 9.30pm Village Hall (Main) - - 01303 813 161
WHIST DRIVE -- 7.30 pm Sellindge Sports & Social Clubhouse, Swan lane. - - 814 511
- WEDNESDAY** ART GROUP – PAINTING for ALL – 2.00pm – 4.00pm Village Hall (Durling) – 01303 812 593
BEES BODS (Dance exercise) – 5.45pm – 6.45pm Village Hall (Main) - - 01303 813 274
TAEKWONDO -- 6.30pm at Sellindge Primary School - - 814 635
AEROBIC BODY BLAST -- 7.00 - 8.00pm Village Hall (Main) - - 01233 820 109
- THURSDAY** LEG, BUMS & TUMS with AEROBICS – 9.15am – 10.15am Village Hall (Main) 07770 984 206 ***NEW***
LINE DANCING – Beginners 12 Noon to 1.00pm Village Hall (Main) – 01303 813 098
LINE DANCING – Easy Intermediate 1.00pm to 2.45pm Village Hall (Main) – 01303 813 161
LINE DANCING -- Intermediate 7.30pm - 9.30pm Village Hall (Main) – 01303 813 161
BINGO -- 7.30pm at Sellindge Sports & Social Clubhouse, Swan Lane. phone 812 437
- FRIDAY** ART GROUP – PAINTING for ALL – 9.30am – 11.30am Village Hall (Durling) – 01303 812 593
SING, DANCE, PLAY – 10am – 10.45am Village Hall (Main) (Term Time) ****NEW****
CUBS -- 6-7.30pm BEAVERS -- 6.30-7.30pm SCOUTS -- 7.30-9.00pm Village Halls - -813 250 (Term t)
- MON / TUES / WED – SELLINDGE POP IN – DURLING HALL – Mon/Wed 8.00am - 12 Tues 8.00am - 4.00pm – 813 475

*****MONTHLY*****

- BABY CLINIC on Monday 11th 2.00pm - 4.00pm at the Sellindge Surgery Appointment only - - 812 616
IMPERIAL DOLLS HOUSE CLUB on Tuesday 12th at 7.00pm Village Hall (Committee Room) - - 812 946
PARISH COUNCIL on Tuesday 12th at 7.30pm Village Hall (Durling) - - Chair 07710 260 757 Clerk 01233 720 392
GET TOGETHER CLUB on Wednesday 13th from 2.00pm – 4.00pm Village Hall (Durling) - - 813 454
GARDENERS' ASSOCIATION on Wednesday 20th 7.30pm Village Hall (Durling) – 813 288 or 01843 597 710
SEQUENCE DANCING CLUB on Saturday 23rd at 7.30pm – 10.30pm – Village Hall (Main) – 01233 629 815
BABY CLINIC on Monday 25th 2.00pm - 4.00pm at the Sellindge Surgery Walk In Clinic - - 812 616
ANGEL CENTRE on Wednesday 27th – 7.30pm to 9.30pm Village Hall (Durling)

SATURDAY 2nd – TABLE TOP FAIR – MAIN HALL – 9am – 1pm

SATURDAY 16th – PILGRIMS HOSPICE JUMBLE SALE

VILLAGE HALL – DOORS OPEN AT 1pm

SOCIAL FOOTBALL TENNIS THE SELLINDGE SPORTS AND SOCIAL CLUB BOWLS POOL DARTS CRICKET

MONDAY 11th – HIGHWAYS ENGLAND

CONSULTATION EXHIBITION FOR PROPOSED

LORRY PARK OPTIONS -

Opening hours Tues to Fri 5.00pm to 10.30pm – Sat 12 Noon to 11pm – Sun 12 Noon to 7.00pm
Contact Social Club on 812 437 www.sellindgeclub.co.uk

SELLINDGE INFORMATION PAGE JANUARY 2016

SELLINDGE PARISH COUNCIL www.sellindgepc.kentparishes.gov.uk  @ParishSellindge 01303 813 271
Sellindge PC Office, Sellindge Village Hall, Sellindge, Kent – TN25 6JY sellindge-parishcouncil@btconnect.com

The Parish Councillors and District Councillors – (Highway issues contact C Mason – 07974 970 342)
Elected May 2015 – Stanley Bull (Chairman) of Swan Lane, Nigel Fursdon (Vice – Chairman) of Moorstock, Chris Mason of Swan Lane, Miss M Varrier – Smith of Greenfields, Jim Bryant of Downs Way.
Co – Opted July 2015 – Janet Tritton of Greenfields.

Clerk and RFO to the Parish Council Linda Hedley - - - - - Clerk to the Burial Ground Linda Hedley

The Parish Council Office is located in the grounds of the Village Hall (behind) and is open to the public on Tuesday's and Friday's – Tuesday 9.00am – 11.30am Friday 3pm to 5.30pm

SHEPWAY (North Downs West Ward) District Councillor – Mrs Jennifer Hollingsbee 01303 812 066

KENT COUNTY COUNCIL (Elham Valley Ward) Councillor – Mrs Susan Carey – 01303 670 561

SHEPWAY DISTRICT COUNCIL – 01303 853 000 (main switchboard) www.shepway.gov.uk

KENT COUNTY COUNCIL – 03000 41 41 41 (helpline) www.kent.gov.uk e-mail county.hall@kent.gov.uk

KENT COUNTY COUNCIL HIGHWAYS – 03000 41 81 81

SELLINDGE RESIDENTS ASSOCIATION – www.slurry.org.uk – sellindgeresidents@gmail.com

POLICE PCSO mob – Nick Hazel 07980 965 439 59007@kent.pnn.police.uk Info only

ALL EMERGENCY SERVICES – POLICE – FIRE & RESUE – AMBULANCE – 999



POLICE CONTACT – MONS JANUARY (TBC) 3.30pm to 4.30pm non emergency 101

In the Village Hall car park, come and meet the local Police, you can discuss your concerns or just get advice.

KCC COMMUNITY WARDEN John Lodge – contact details to follow

DOCTORS SURGERY – 812 180 website www.sellindgesurgery.nhs.uk Out of hours phone 111

Patient Participation Group – Vera Orsbourne – 812 237

Minor Injuries small wounds, burns – Hamstreet (8am – 6pm) 08444 773 989 Wye (8.30am – 6pm) 08444 878 419

Dental emergency – (No Dentist) – 0808 238 9797 – evenings and weekends – 01634 890 300

Late night pharmacy – Boots (Sevington) – 01233 503 670

HOSPITALS – William Harvey (Ashford) 01233 633 331 - - - - - Royal Victoria (Folkestone) 01303 850 202

Kent and Canterbury (Canterbury) 01227 766 877 All hospitals website www.ekhuft.nhs.uk

SELLINDGE PRIMARY SCHOOL – 01303 812 073 website www.sellindge-ashford.kent.sch.uk

LITTLE LEARNERS AT SELLINDGE PRE-SCHOOL MON – FRI 8am - 6pm Sellindge School 814 968

KCC MOBILE LIBRARY All times approx. *JANUARY* www.kent.gov.uk/leisure_and_culture/libraries.aspx

Mondays – 10.20am to 10.50 am A20 Hythe lay – by near Swan Lane, 10.55am – 11.25am Greenfields lay – by.

Wednesday's 6th and 20th – 12 10am – 12.30pm Coopers Lane / Stone Hill junction,

12.35pm – 12.50pm Lay by top Barrow Hill and 2.50pm – 3.10pm Lay by at the St Mary's Church

AGE UK HYTHE & LYMINGE – 01303 269 602 www.ageuk.org.uk/hytheandlyminge

AGE UK FOLKESTONE – 01303 279 621 www.ageuk.org.uk/folkestone

CITIZENS ADVICE BEARU – Folkestone 01303 249 310 (10am – Noon Tues – Fri) www.shepwaycab.co.uk

Ashford 01233 626 185 (9.30am – 4.30pm Mon – Tues & Thurs)(1pm Wed & Fri)

THE SAMARTITANS – Folkestone 01303 255 000 Ashford 01233 610 000

UTILITY EMERGENCY

POWER CUT – 0800 783 8866 or text 'power' and your 'postcode' to 80876 www.ukpowernetworks.co.uk

Please note that in a power cut telephones that have an electric basestation will not work, it is a good idea to have at least one conventional phone, that just plugs into the phone socket, these are not normally affected.

WATER – www.affinitywater.co.uk emergency 0345 357 2401 Mon – Fri 7am – 8pm Sat 8am – 4pm

SEWAGE – www.southernwater.co.uk emergency 0330 303 0368

SELLINDGE VILLAGE HALL Registered Charity 302833  Anybody wishing to book the Village Hall ring 01303 813 250 any day except Sunday and preferably no later than 8.30pm. Bookings **MUST** be confirmed in writing as soon as possible. We now have an e-mail address. sellindgevillagehall@gmail.com

SELLINDGE SPORTS & SOCIAL CLUB  Anyone wishing to book the clubhouse or pitches call 812 437 from 5pm Tuesday to Sunday or e-mail club@sellindgeclub.co.uk Fully licensed bar, catering available.

ITEMS FOR THE FEBRUARY 2016 NEWSHEET Should be delivered to the Parish Council Office or e-mail nnwfursdon@aol.com by 2200 hours (10pm) on **WEDNESDAY 20th JANUARY 2016** with a 'contact' name, address and / or tel number (not for publication) phone 07788 313 414 and I will collect

Containerised Storage

Available in southeast of Ashford

Fully secure

Indoors or outdoors

Competitive rates

Tel: 01233 720871 / 812237

Email: janestafford@tdenneandsons.co.uk

East Kent Foot Care

Mobile Foot Health Practitioners

Jo Shapter BSc (Hons), MCFHP, MAFHP

Treating and managing common foot problems, corns, callus, verrucae, thickened nails, toe nail management, fungal problems, diabetic foot assessments etc.

Call: 07745 532075

info@eastkentfootcare.co.uk

Members of the British Association of Foot Health Professionals



The Bowen Technique

BOWEN THERAPY

in Lympe, Hythe, Kent

The Bowen Technique a gentle remedial treatment for pain management, back pain, frozen shoulder, headaches, migraines, digestive disorders, asthma, anxiety and more: £30
Classic Facial cleanse, tone, exfoliation, face, neck and shoulder massage, mask and moisturise: £30



****GIFT VOUCHERS AVAILABLE****

Indian Head or Aromatherapy relaxing shoulder, head and face massage: £25

*** Sienna X spray tanning £20 ***

Lynne Rodgers, Bowen Technique Practitioner Cert E.C.B.S CIBTAC I.H.B.C Cert Ed.

Call 01303 268 910 35 The Ridgeway Lympe CT214PW

www.lynnrogersbowentechnique.co.uk lynnealexrogers@gmail.com

J. HICKINBOTHAM

Handyman and Computer Services

Inside and Outside work undertaken. Computer problems solved.

Tel: 01303 812501

Email: hickinbotham@btinter.net.com

Swan Lane, Sellindge